



NORTH AMERICAN RESCUE
www.NARescue.com • 888.689.6277

- ☐ **80-0471** Public Access Bleeding Control Station Basic (Vac Pouch)
- ☐ **80-0472** Public Access Bleeding Control Station Intermediate (Vac Pouch)
- ☐ **80-0473** Public Access Bleeding Control Station Advanced (Vac Pouch)
- ☐ **80-0474** Public Access Bleeding Control Station Basic (Red Nylon)
- ☐ **80-0475** Public Access Bleeding Control Station Intermediate (Red Nylon)
- ☐ **80-0476** Public Access Bleeding Control Station Advanced (Red Nylon)

INSTRUCTIONS FOR USE

Apply Gauze & Compress

1. Identify & Cover the wound
2. Apply Direct Pressure until Bleeding is controlled
3. Wrap Wound with ETD (See next Step)

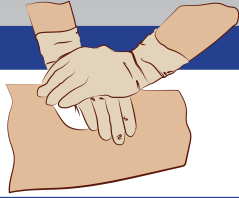

Responder Emergency Trauma Dressing (ETD)

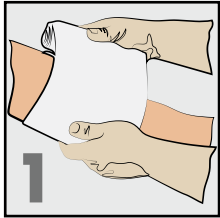

1
Place Pad over the Wound

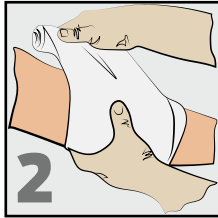

2
Wrap around the Limb, covering the pad

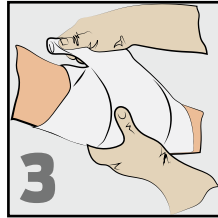

3
Pull ETD Firmly, and continue to Wrap, covering the wound completely
Secure with velcro style fastener when wrap is complete



Open Chest Wound

(Intermediate & Advanced Kits)
Apply HyFin® Chest Seal

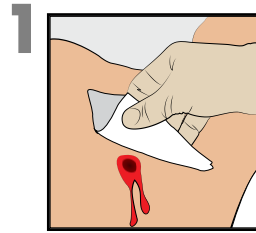

1
Wipe Wound with Gauze

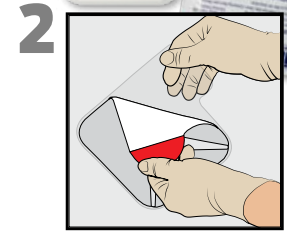

2
Peel Seal from Backing using Red Tab

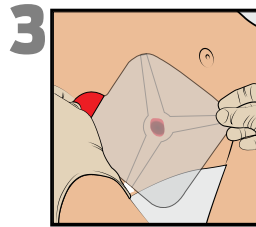

3
Center over wound

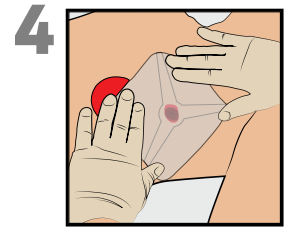

4
Firmly Press onto skin

Major Bleeding on Arm or Leg Apply C-A-T® Tourniquet

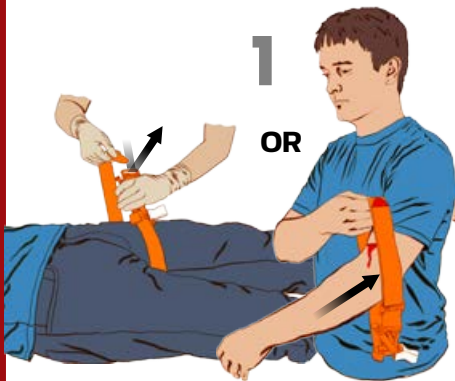

1
OR



OR

TWO-HANDED APPLICATION
Route the band around the limb, **pass the red tip through the slit of the buckle**, and position the C-A-T® 2-3" above the bleeding site directly to the skin.*

ONE-HANDED APPLICATION
Insert the injured limb through the loop in the band and position the C-A-T® 2-3" above the bleeding site directly to the skin.*

Pull band tightly and fasten it back on itself all the way around the limb, but not over the rod clips.

Band should be tight enough that **tips of three (3) fingers CANNOT be slid between the band and the limb**. If the tips of three (3) fingers slide under band, retighten and re-secure.



3
Twist the rod until bleeding has stopped.



4
Secure the rod inside a clip to lock it in place. Check for bleeding and distal pulse. If bleeding is not controlled, or distal pulse is present, consider additional tightening or applying a second C-A-T® above and side-by-side to the first. Reassess.



5
Route the band between the clips and over the rod. **Secure rod and band with TIME strap**. Record time of application.



*If you cannot be sure or cannot take the additional time to examine where the bleeding is coming from based on the situation, the C-A-T® can be effectively applied over clothing as high on the arm or leg as possible. The C-A-T® must NOT be applied over solid objects within the clothing. As soon as the situation permits, the injured limb should be evaluated and the C-A-T® re-positioned 2"-3" above the injury directly to the skin.